

Integrable marking machine

Compact, 45 x 45mm marking window.

UTILISATION: ideal solution for the marking of metal and plastic parts, of various shapes and surface conditions (automobile, mechanical, cast, electromechanical, ...).

ENVIRONMENT: conceived for industrial integration:

- on production lines,
- in automatic or semi-automatic assembly or test stations.

WATER RESISTANT: ideal solution for integration in severe environments:

- Lubricant spray or metal chips.
- Dirty environments.
- Oil mist.
- Humid areas.

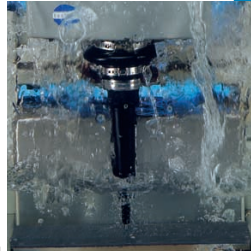

MARKING IN THE MOST DIFFICULT LOCATIONS

Extra long stylus (180mm) permits access to difficult marking areas: complex pieces with grooves and tenons, inside engine blocks, transmission casings, ...



SIMPLIFIED INDUSTRIAL INTEGRATION

- **User-friendly:** The T201W marking software fast and easy composition of marking files. T201W, installed on a PC, provides a user-friendly Windows® interface.
- **Control the marking head by:**
 - Control unit functioning in independent mode (PC disconnected).
 - PLC or other information system, via RS232 link.
 - File selection from memory, from PLC via the Input / Output board.
- **Easy to mount**
 - Simple attachment: 2 M8 mounting holes.
 - 2 Ø5 positioning holes.

FEATURES

- Create / Modify / Save marking data.
- Calculation of variable data: date codes (several formats available), shift codes, serial numbers.
- Management text style:
 - Choice of fonts.
 - Choice of logos.
 - Compression, spacing, automatic centering.
 - Linear marking, angular, radial, inclination, inverted, mirrored.
- Downloading of custom fonts and logos.

TECHNICAL SPECIFICATIONS

Environment:

- Dimensions (l x h x w): 196x155x184mm (without stylus and connectors)
- Weight: 5.2Kg
- Air supply: operating pressure from 5,5 to 8bars, (6bars nominal) with Ø 6mm pneumatic fitting.
- Consumption (pneumatic version): 0.4 à 0.7 Nl / character, Max: 3 SCFM.
- Operating temperature : +5 to +45 °C (+41 to +113 °F).

Accessories / Adaptations:

- 3m Head/CCU cord (standard), 6m, 10m or 15m.
- Mounting bracket.
- Height adjustment system (± 22 mm).
- 6l / 40 or 8l / 80 board.

Options:

- Downloading of fonts and logos (HPGL).
- T201W Windows® marking software.
- Data input via RS232 link.
- Rack mount UC201 (19" 3U).
- Waterproof cabinet (IP54) for UC201.

Norms:

- Directive "Machine" 89/392/CEE.
- Directive "Electromagnetic compatibility" 89/336/CEE.
- Directive low voltage "Electric devices" 73/23/CEE.
- Complies with Part 15 of the FCC rules.

UC201 control unit:

- Dimensions (l x h x w): 420 x290x100mm (without connectors)
- Weight: 6.5Kg
- Electrical supply: 115 or 230 VAC
- Consumption: 100 W
- Memory capacity: 121Kb
- Data input by:
 - PC using T201W Windows® software.
 - PLC via RS232 link (DB9 connector).
 - Other information systems via RS232 link.
 - Bar code readers via RS232 link (optional).

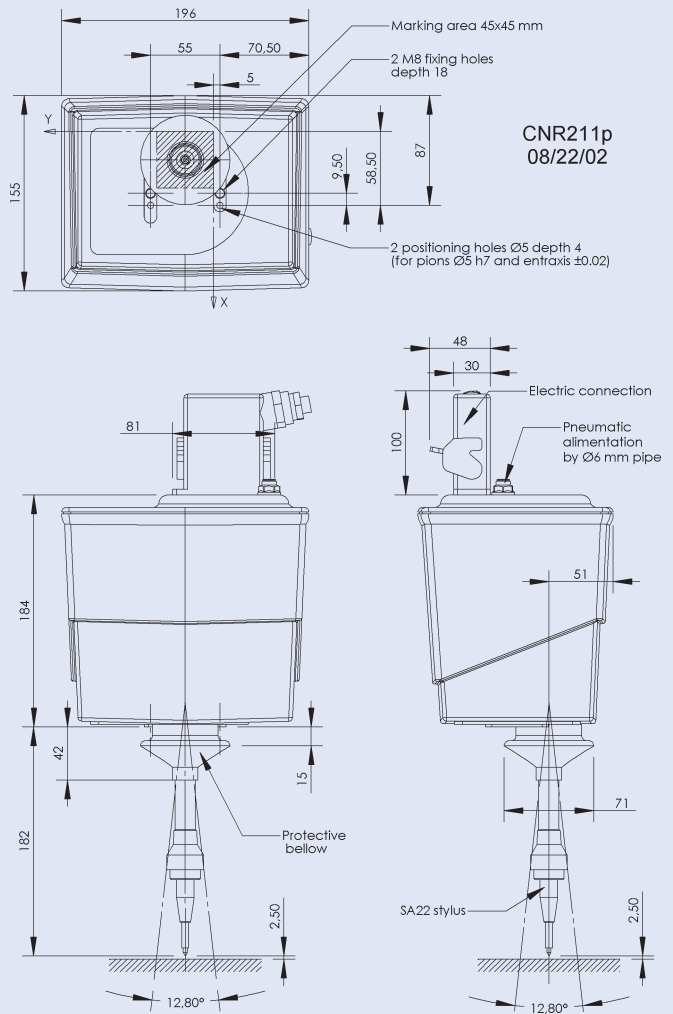

- File selection from memory:
 - by 6l / 40 or 8l / 80 board.
 - by RS232 connection.
- Communication interface:
 - Start of marking.
 - End of cycle.
 - Reset.
 - Machine ready (in independent mode).



A MARK WHICH DEFIES TIME

114, quai du Rhône - F-01708 MIRIBEL Cedex
Tel +33 (0)4 78 55 85 50 - Fax +33 (0)4 78 55 85 60

E-mail : if@technifor.com

www.technifor.com



Technifor SA - Miribel site - F